

Bathroom Mirror Installation Instruction

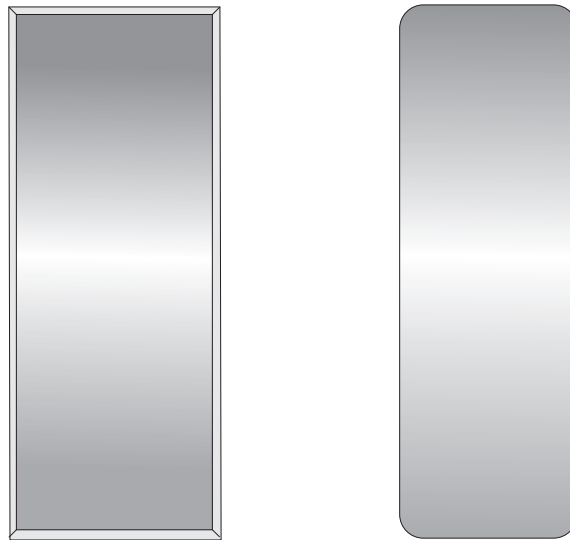

TOOLS



ELECTRIC DRILL



HAMMER

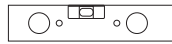

RULER



TAPE MEASURE

Installation drawing

Mark the two holes for the screws onto the wall with the center diameter for 155 mm

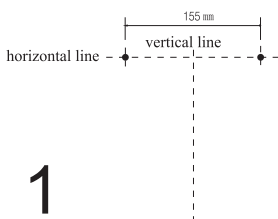

1

Drill into the centre of the marked holes, diameter and depth to suit wall plugs provided.

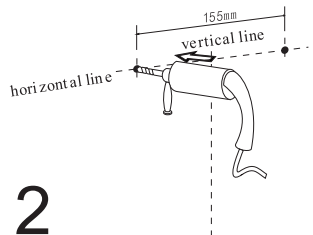

2

Place plastic wall plugs in holes.

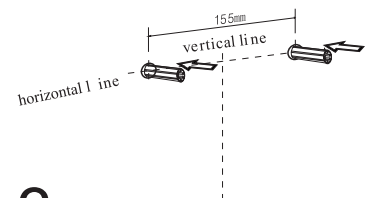

3

4

Spin into the drilling hole on the wall with the bent-head screws in clockwise direction. (20-22 mm appropriate exposed)

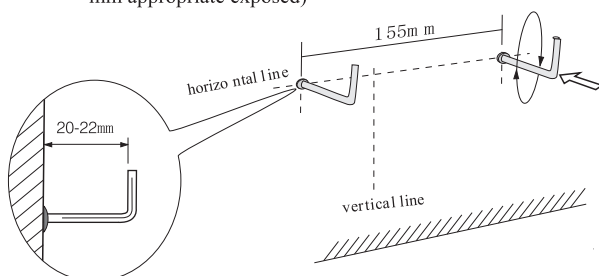

5

Place the mirror on the wall.

